



INSTALLATION AND OPERATING INSTRUCTIONS VESTA HOME FUNKTIMER



This manual is suitable for the following products:

- Vesta Home Funktimer (01824005)

Anleitungsnummer: 85900624 A1



Read the manual before starting the installation.
Failure to follow the instructions may result in defects that are not covered by the warranty. Errors and technical changes excepted.



INHALT

■ Safety Instructions	2
■ Technical data	3
■ Installation / Wiring Diagram	4
■ Programming	5
■ Maintenance / Warranty	16

SAFETY INSTRUCTIONS









GENERAL INFORMATION

These safety instructions are part of the product and must be fully read and understood before installation, electrical connection, commissioning and use.

- The controller is intended exclusively for its designated purpose.
- Installation, wiring and commissioning may only be carried out by a qualified electrician.
- National regulations as well as DIN VDE 0100/0700 and the requirements of local energy suppliers must be observed without exception.
- A damaged controller must not be put into operation.
- Any changes or modifications to the device are not permitted; they will void the warranty and may cause hazards.
- The operator must ensure that all subsequent users receive these safety instructions.

INTENDED USE

Manual and automatic control of electrically driven roller shutters:

	Shutters		Awnings		Pleated Blinds
	Internal Roller Blinds		External Venetian Blinds		Plafond Blinds
	Screens		Internal Venetian Blinds		Roman Blinds

CRITICAL SAFETY WARNINGS



ELECTRICAL HAZARDS

DANGER – Risk of fatal electric shock.

Disconnect the mains voltage completely before installation and before working on the device.



RADIO AND EMC INFORMATION

CAUTION – Malfunctions due to electromagnetic interference.



HAZARDS FROM MOVING SUN SHADING SYSTEMS | WARNING

Risk of injury due to crushing, shear points or uncontrolled movement.



NOTE

The complete safety instructions can be found at: www.vestamatic.com/safety



SCAN ME

SUPPORT/CONTACT

Vestamatic International GmbH
 Am Tannenbaum 2 | 41066 Mönchengladbach
 E-Mail: info@vestamatic.com

TECHNICAL DATA

KURZBESCHREIBUNG

- A maximum of 10 channels can be stored in a Vesta Home radio timer. When an additional channel is added beyond this limit, the most recently stored channel is overwritten cyclically.
- Compatible Transmitter: THW3001, THW3015, THW3215, TWW3001, TWW3015, THB3001, THB3015, THW2001, THW2015, THW2215, THW2501, THW2515, TWW2001, TWW2015, TWW2606, THW1001, THW1005, TMB1001, TMW2001

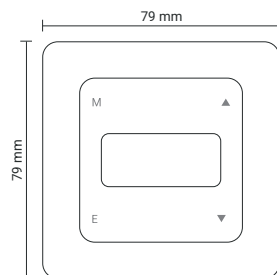

PARAMETER	WERT
Power supply	230 VAC, 50 Hz
Operating voltage range	100 VAC – 240 VAC
Rated power	500 W
Max. output current	5 A / 250 V
Operating temperature	–20 °C bis 65 °C
Radio range	L1 (Outdoor) 150m L2 (Indoor) 40m
Radio frequency	433,05–434,79 MHz
Conformität	CE



NOTE:

In jog mode, the motor runs in steps when the up or down button is pressed briefly. The motor runs continuously when the up or down button is pressed and held for 2 seconds.

INSTALLATION / WIRING DIAGRAM

RADIO RANGE

i NOTE
The effective radio range may vary depending on the actual environment.

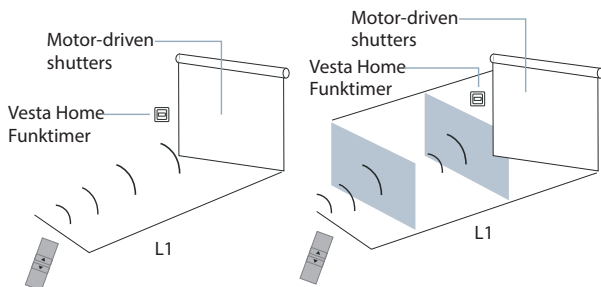

Radio range	L1 (outdoor) 150m
	L2 (indoor) 40m
Radio frequency	433,05–434,79 MHz

EXPLANATION OF BUTTONS

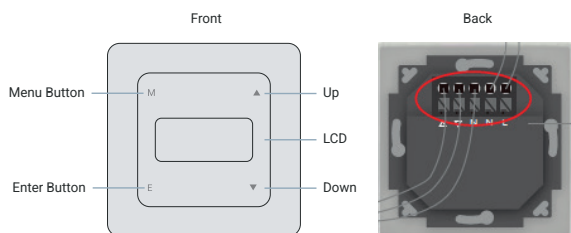

INSTALLATION NOTES

- Minimum distance between receiver and floor: ≥ 1.5 m
- Minimum distance between receiver and ceiling: ≥ 0.3 m
- Minimum distance between receiver and walls: ≥ 0.3 m
- Minimum distance between receiver and receiver: ≥ 0.2 m

WIRING DIAGRAM

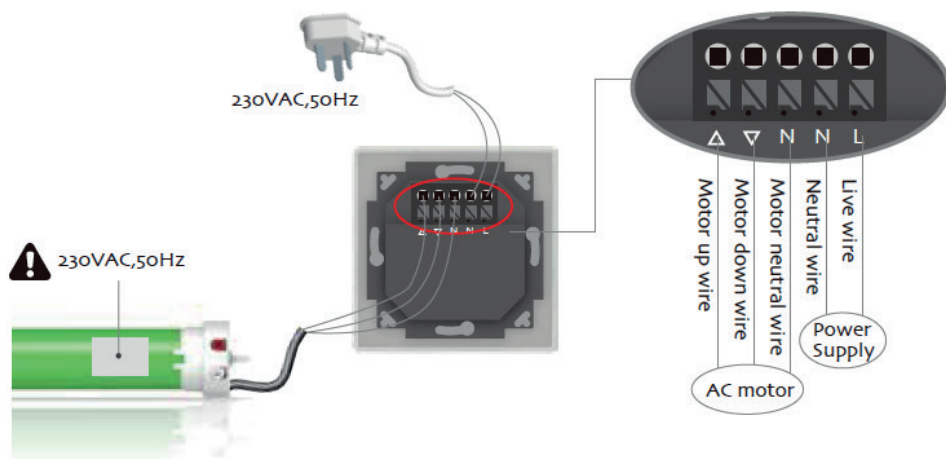

PROGRAMMIERUNG

MODE SWITCH

- 1. Manual mode: no timer function
- 2. Automatic mode (3 types):
 - FIRST TYPE:** From Monday to Sunday, a different switching time can be set for each day, with up to 7 switching times in total.
 - SECOND TYPE:** Only one switching time group is set, which applies from Monday to Sunday.
 - THIRD TYPE:** Two switching time groups: one for weekdays (Monday to Friday), one for weekends (Saturday and Sunday)
- 3. Repeated operation switches cyclically between the modes.

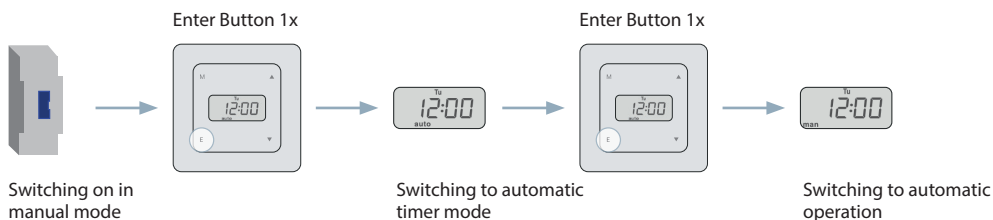

SETTING THE AUTOMATIC TIMER MODE

AUTOMATIC TIMER MODE FOR ASTRONOMICAL OPERATION

Opening time (up movement):

- If the astronomical time deviation is set to "off", the automatic opening time is executed.
- If the astronomical time deviation is set to "on", the astronomical sunrise time plus the set deviation value is executed.

Closing time (down movement):

- If the astronomical time deviation is set to "off", the automatic closing time is executed.
- If the astronomical time deviation is set to "on", the astronomical sunset time plus the set deviation value is executed.
- Repeating the same procedure will deactivate the automatic astronomical timing mode.

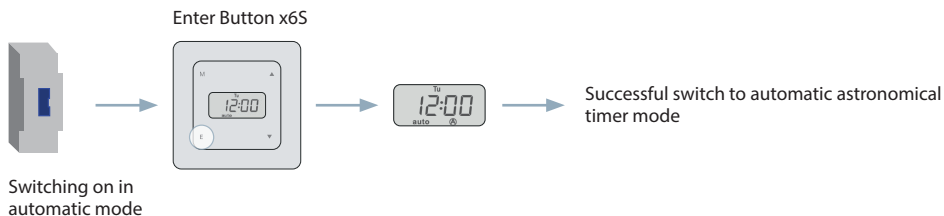

PROGRAMMING

SETTING THE AUTOMATIC TIMER MODE

AUTOMATIC RANDOM TIMER MODE

- Repeating the same procedure will deactivate the automatic random timer mode for time control.
- The opening and closing times correspond to the automatic time control, randomly ± 15 minutes.

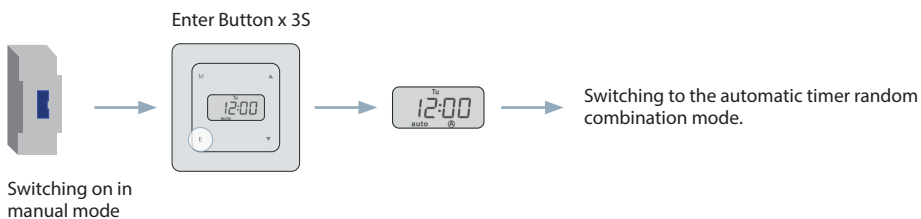

SETTINGS FOR TIME FUNCTION PROGRAMMING

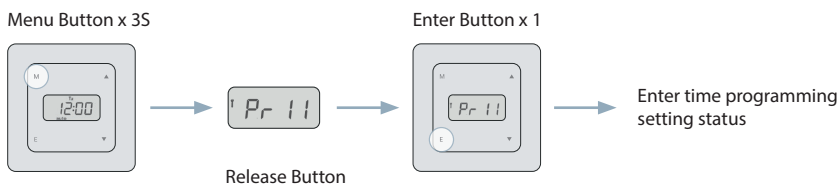
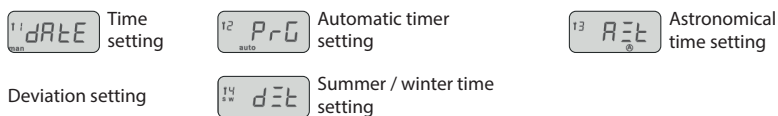

TIME SETTING

After calling up the time programming, press the menu button once to exit the menu without saving the programming.

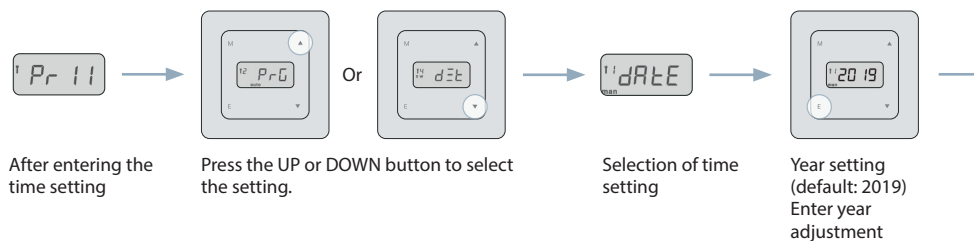

PROGRAMMING

TIME SETTING

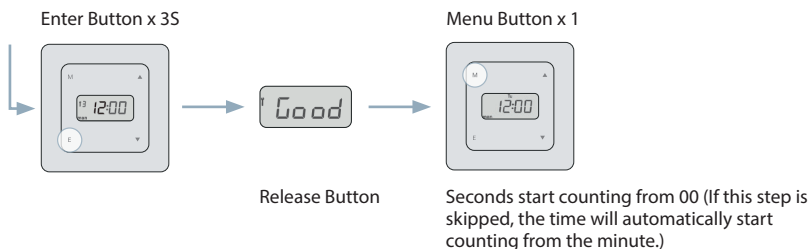
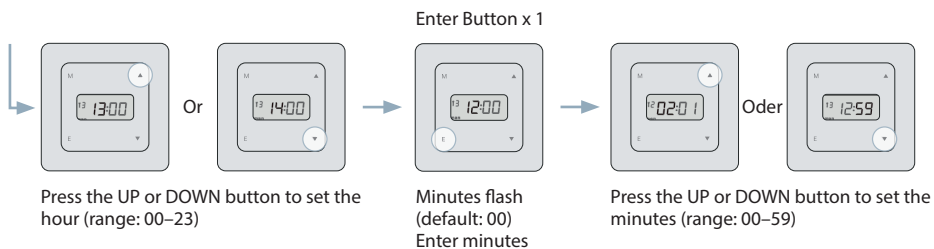
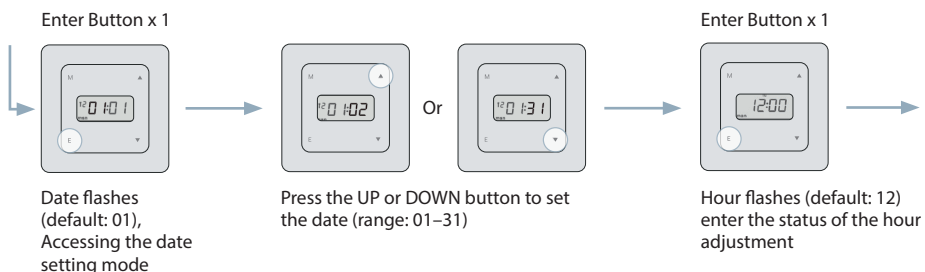
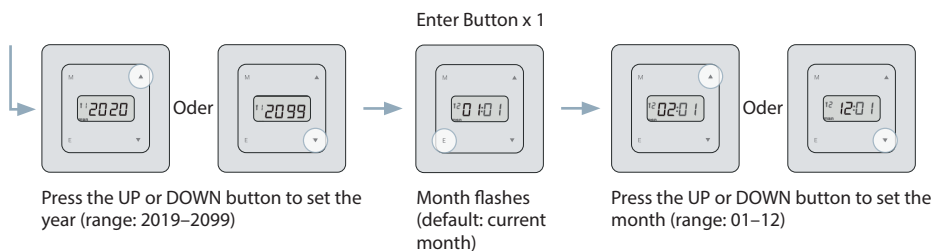

PROGRAMMING

AUTOMATIC TIME SETTING

- If you want to adjust the settings, press the Menu button to return quickly without saving the programming.
- If no button is pressed for more than one minute during programming, the setting process is automatically terminated.
- If the time setting shows "--:--", this means that no UP or DOWN time is set for that day.

Automatic mode (3 types):

- 1.) From Monday to Sunday, different times can be set individually for each day (up to a total of 7).
- 2. One group of times is set, which applies from Monday to Sunday.
- 3. Two groups of times are set: weekday times (Monday to Friday) and weekend times (Saturday and Sunday).

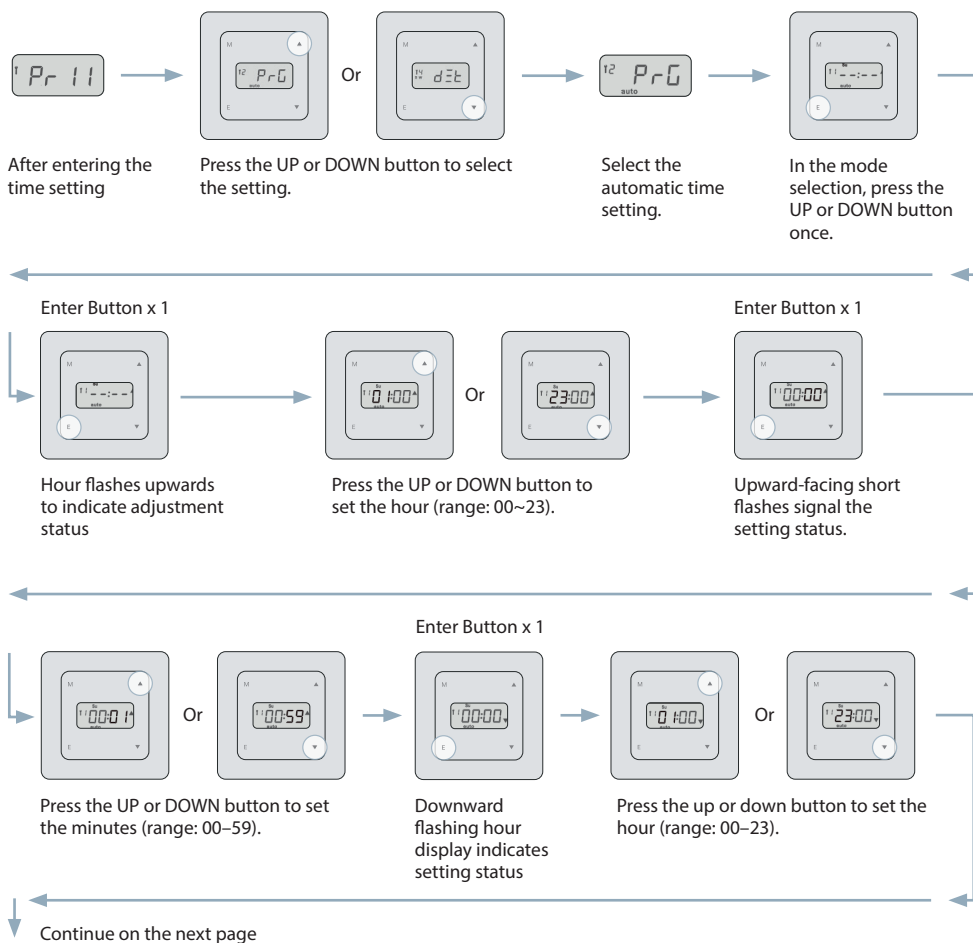

PROGRAMMING

AUTOMATIC TIME SETTING

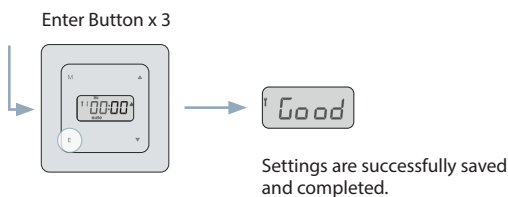
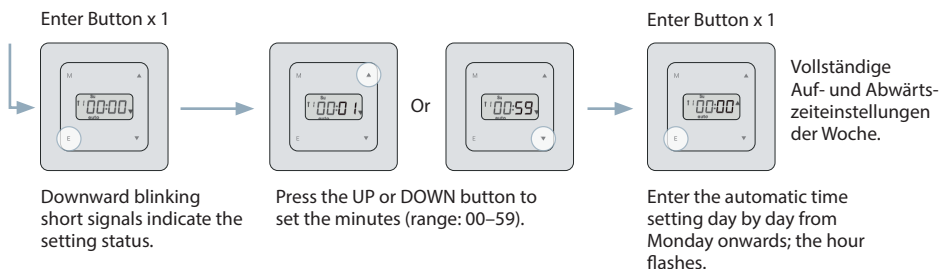

ASTRONOMICAL TIME OFFSET SETTING

- During programming, press the Menu button once to exit quickly without saving.

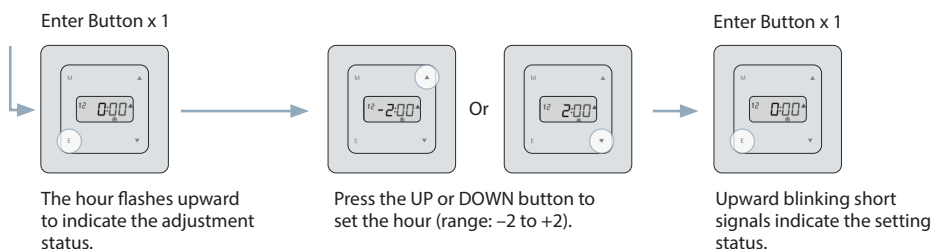
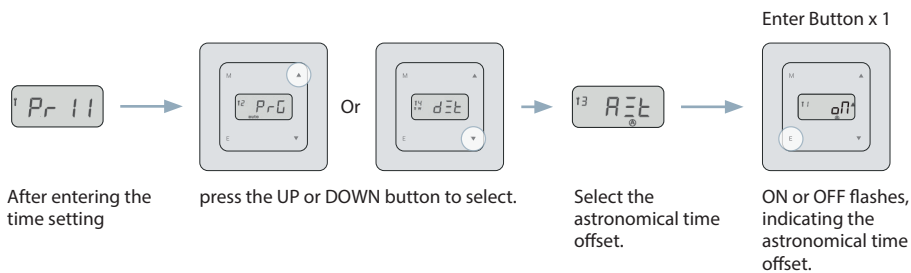

Continue on the next page

PROGRAMMING

ASTRONOMICAL TIME OFFSET SETTING

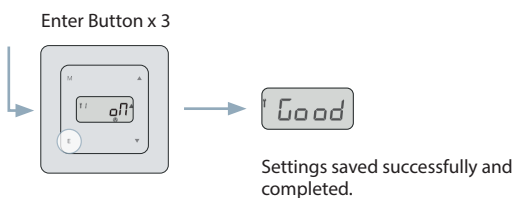
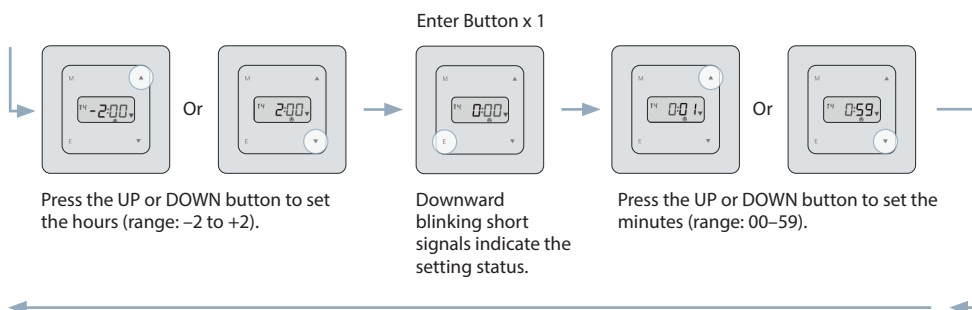
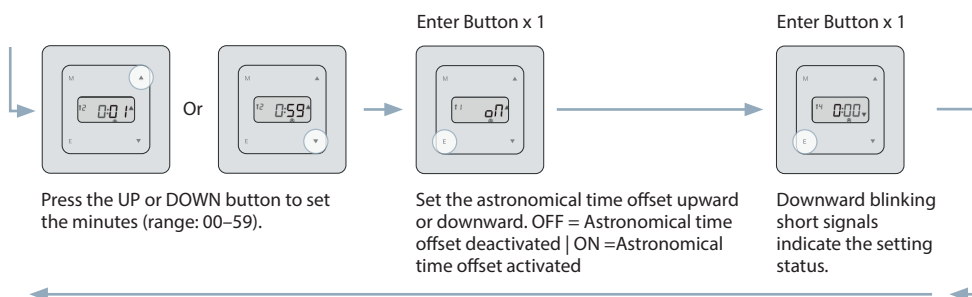

SUMMER TIME / WINTER TIME

- To adjust the settings, press the Menu button to return quickly without saving.
- ON means summer/winter time is switched automatically.
- OFF means summer/winter time is not switched automatically.
- Default setting: ON
- European summer time:
 - Starts on the last Sunday in March at 02:00 (clock moves forward by one hour)
 - Ends on the last Sunday in October at 03:00 (clock moves back by one hour)

Continue on the next page

PROGRAMMING

SUMMER TIME / WINTER TIME

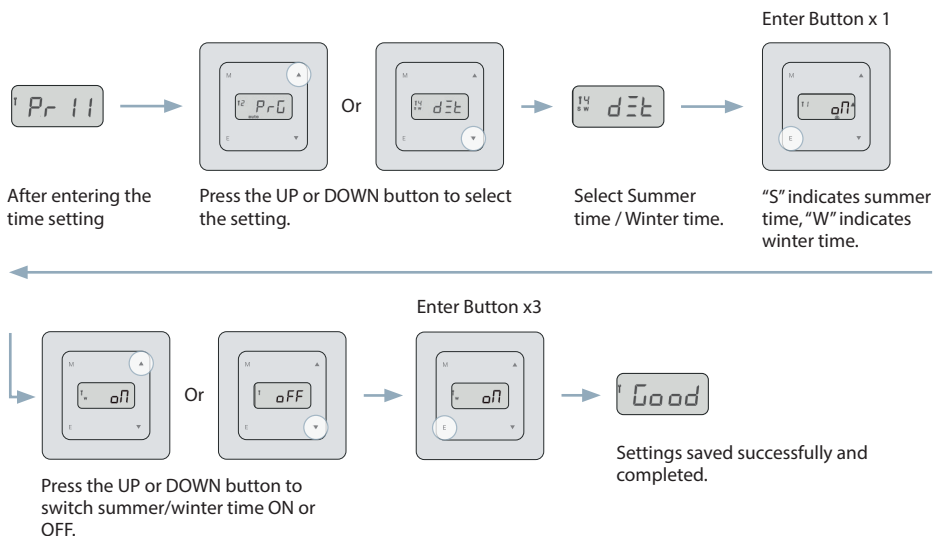

PROGRAMMING SETTINGS FOR RADIO AND MOTOR FUNCTIONS

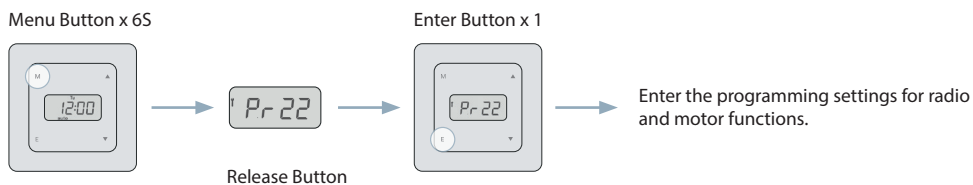
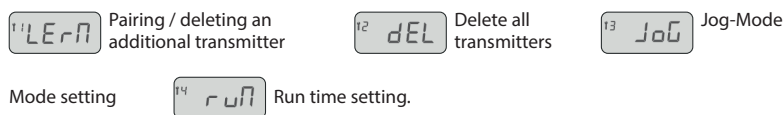

PAIRING / DELETING AN ADDITIONAL TRANSMITTER

Method 1

- 1. In settings mode, press the Menu button to exit quickly without saving the programming.
- The receiver can store a maximum of 10 channels. If more than 10 channels are stored, adding a new channel will overwrite the last stored channel cyclically.
- If the same procedure is repeated for the same transmitter, the corresponding transmitter will be deleted.

PROGRAMMING

PAIRING / DELETING AN ADDITIONAL TRANSMITTER

METHOD 1

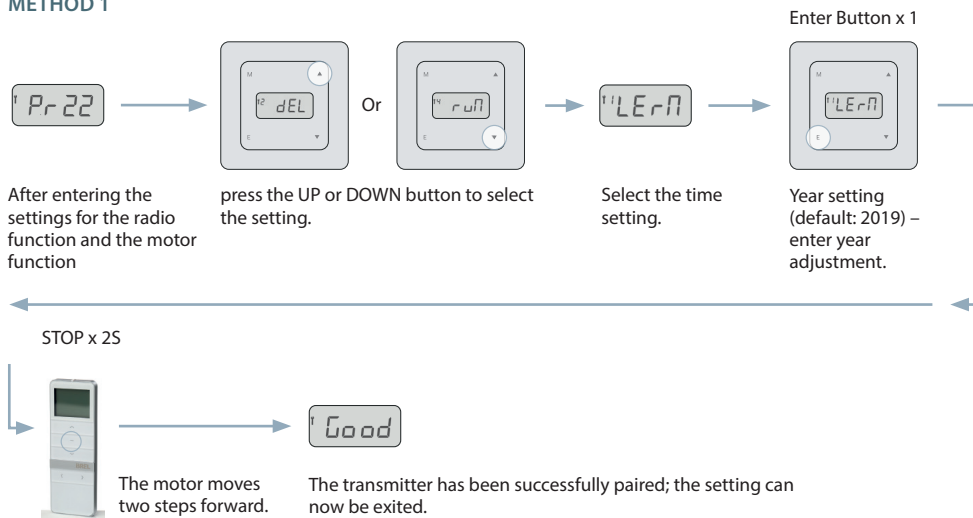

METHOD 2

- This operation only takes effect after the virtual percentage limit has been set. (a) as an existing transmitter (b) as a new transmitter for pairing/deleting

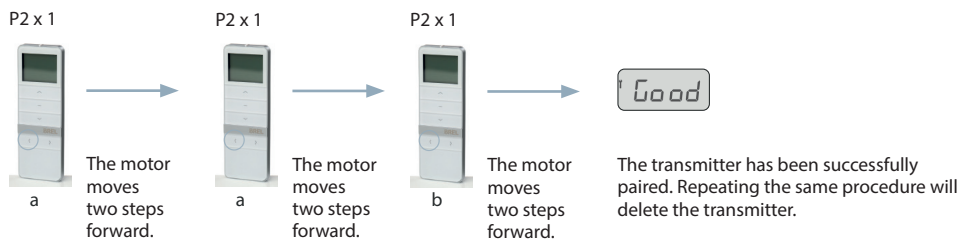

DELETE ALL TRANSMITTER

- This operation only takes effect after the virtual percentage limit has been set.
- In settings mode, press the Menu button to exit quickly without saving the programming.

Continue on the next page

PROGRAMMING

DELETE ALL TRANSMITTER

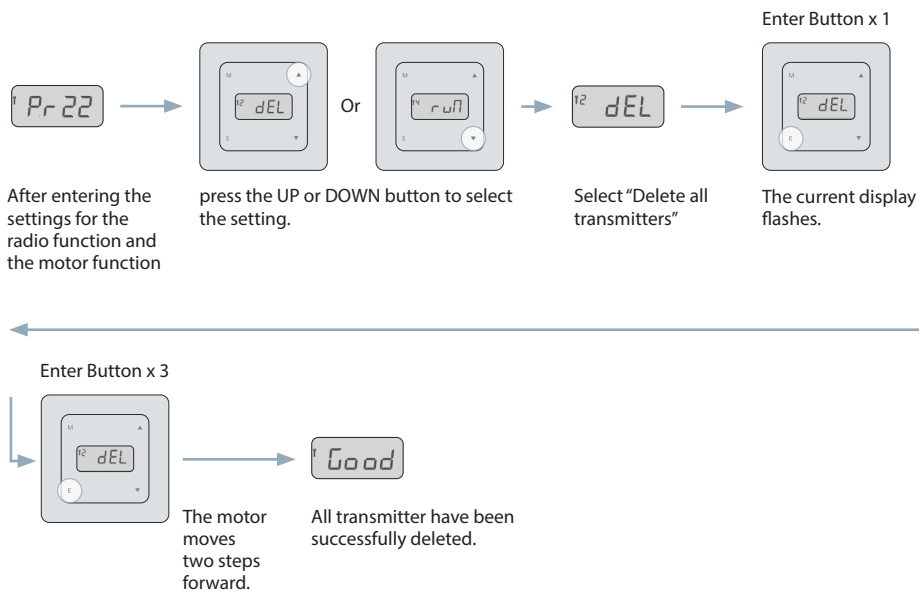

SETTING JOG-MODE

METHOD 1

- In settings mode, press the Menu button to exit the program quickly without saving.

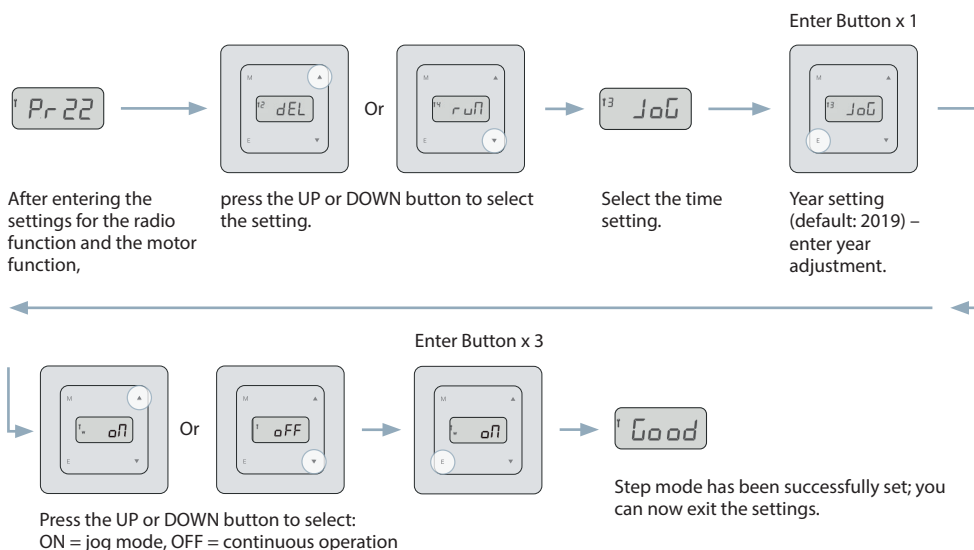

PROGRAMMING

SETTING JOG-MODE

METHOD 2

Up + Down x 5S



The motor moves one step forward.

STOP x 1



The motor moves one step forward.

The motor switches to jog mode.

The motor switches to continuous operation.

The motor moves two steps forward.

RUN TIME SETTING

- If the set time is greater than 0, the virtual percentage limit is deleted first.
- In settings mode, press the Menu button to exit the mode quickly without saving.
- The run time range is 1 s to 360 s; factory setting is 120 s.

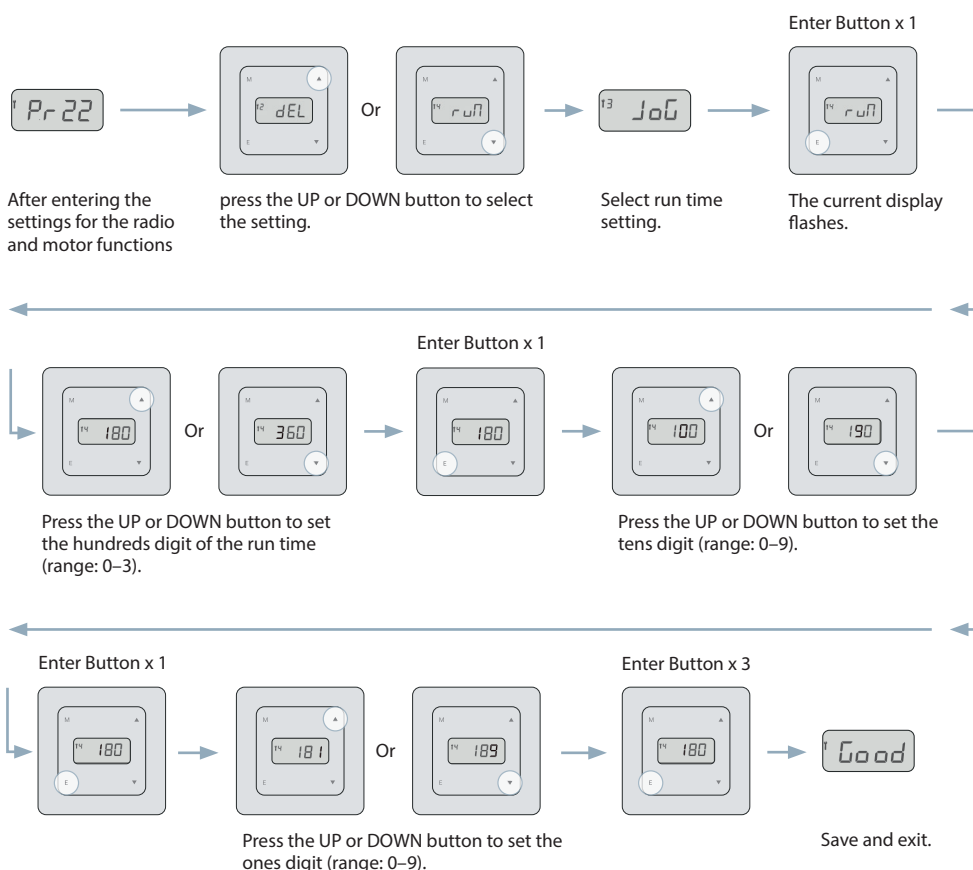

PROGRAMMING

RUN TIME SETTING

1. LEARNING VIRTUAL PERCENTAGE LIMITS

- Before the virtual percentage limits are learned, the motor is in step (jog) mode.
- After successful learning, the run time in the settings menu is set to 0.

Up + Down x 2S

Menu + Enter x 3S

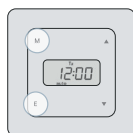

The motor starts running automatically once up and down and then moves to the upper end position.

The motor moves two steps forward.

The virtual percentage limit has been successfully learned.

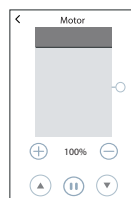
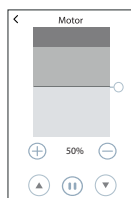
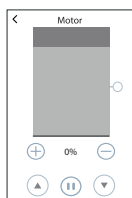

2. DELETING VIRTUAL PERCENTAGE LIMITS

AB + STOP x 2S

Menu + Enter x 3S

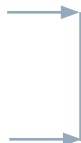
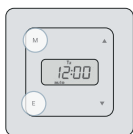

The motor moves two steps forward.

The virtual percentage limit has been successfully deleted.

DIRECTION OF ROTATION

Up + Down x 2S



The motor moves one step forward.

After releasing the buttons, the direction of rotation is successfully changed



NOTE

This function is only effective if no virtual percentage limit is set.

PAIRING / DELETING WIND-SUN SENSOR

- (a) as an existing sensor, (b) as a new sensor for pairing/deleting

P2 x 1

P2 x 1

P2 x 1



The motor moves one step forward.

a



The motor moves one step forward.

a



The motor moves two steps forward.

b

The wind-sun sensor has been successfully paired. (b) Durch die Wiederholung des gleichen Vorgangs wird der Wind-Sonnen-Sensor gelöscht. (b)

PROGRAMMING

ACTIVATING / DEACTIVATING WIND AND SUN SENSOR DETECTION

- The Default setting is ACTIVE. If this function is deactivated and the controller does not receive a response signal from the wind/sun sensor within 30 minutes, the controller will continue to operate normally.

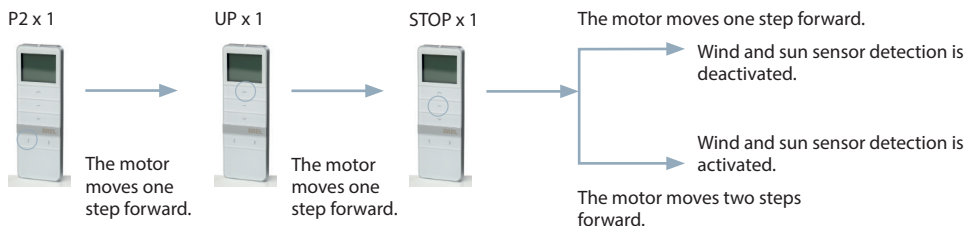

ACTIVATING / DEACTIVATING SUN SENSOR DETECTION

- The default setting is ON.

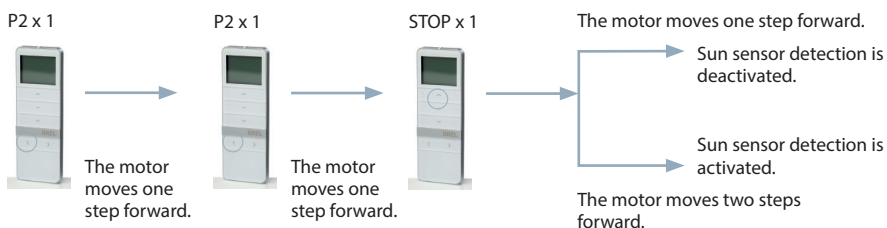

WARRANTY/MAINTENANCE

Principally, the General Terms and Conditions of the manufacturer, Ves-tamatic GmbH apply. The terms and conditions are part of the sales documents and handed over to the operator upon delivery. Liability claims for personal or material damages are excluded when they can be attributed to one or more of the following causes:

- Unintended use of the product.
- Opening of the product by the customer.
- Improper installation, commissioning, or operation of the product.
- Non-compliance with the specifications.
- Non-observance of the safety provisions and instructions of the Operating Instructions.
- Operation of the product with improperly installed connections, defective safety devices or improperly installed safeguards.
- Modifications to the product.

MAINTENANCE

The Time receiver is maintenance free.